

Worksman PortoTrike: The Compact Deluxe Adult Folding Tricycle

Assembly Instructions, Parts List, and Owner's Manual for PT, PT2F, PTCB, PT2CB, PT3CB

Congratulations on your purchase of the Worksman PortoTrike Compact Folding Tricycle, one of the most popular adult recreational tricycles of all time. This is a recreational tricycle for the consumer market, with a recommended weight limit of 210-225 pounds, depending on brakes chosen. The low step-through and compact frame design are ideal for those riders who simply want to ride leisurely, safely, and comfortably. The PortoTrike has been carefully manufactured in the USA using domestic and imported parts, with simple finishing assembly required. *It is always recommended to have a qualified bicycle mechanic perform repairs and assembly of any cycle.* Please read these instructions thoroughly prior to assembling and riding.



Failure to have this cycle professionally assembled could result in injury or death.

Tools Needed for Assembly: Phillips and Flathead Screwdrivers, Large Adjustable Wrench

(A) Unfolding the PortoTrike:

- Remove protective bubble wrap and cardboard.
- Located at the PortoTrike's hinge, find the quick-release arm, loosen it, and swing towards the rear.
- Now that hinge is free, unfold the trike so that the frame is straight.
- Slide quick-release arm's pin down through frame hole, pull lever forward, and tighten.

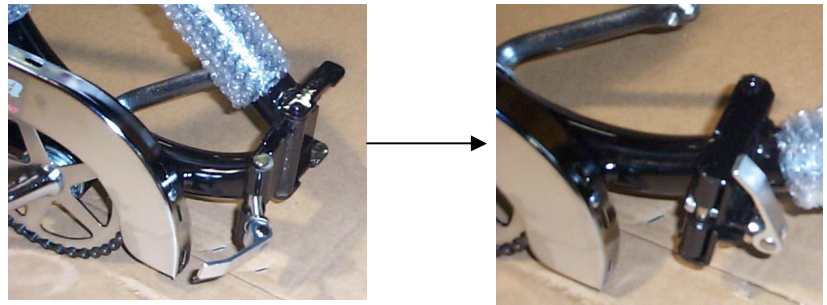

(B) Steps to Attach Front Wheel/Front Fork to Main Frame:

- Slide one bearing (49B) onto the fork steerer tube cone, balls facing up.
- Slide fork assembly into the front of the frame; make sure that bearing is flat.
- Place the remaining bearing (49B), balls facing downward, onto the steerer tube.
- Thread top adjustment cone (52B) onto this tube. Tighten the bottom. Again, make sure both bearings are sitting evenly inside their respective cones. Hand-tighten until tube is tight enough the sit steady but can still turn freely.
- Place keyed silver washer (53) above the adjustment cone. (Key inside slot in tube.)
- Next, place quick release clamp (4911B- it has a black handle) above washer, with clamp arm towards the back of the cycle.
- Next, place reflector bracket (5030F) on top of the clamp with key inside slot as done before. Make sure holes point upwards.
- Place 2 regular washers (53B) above the reflector bracket, followed by the small black-keyed washer (53BWO), and then screw on the threaded lock nut securely (54B).

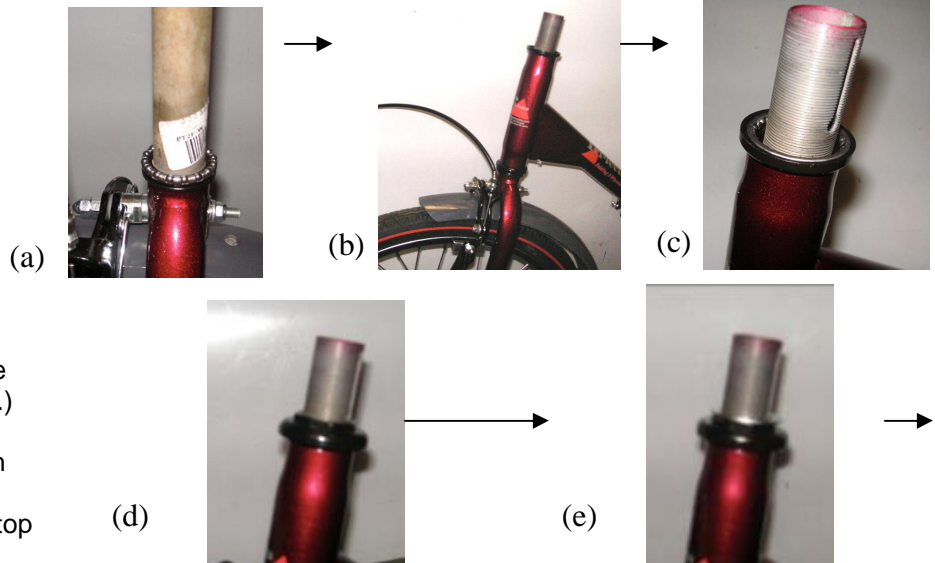

Note: Headset assembly should be tight enough so all pieces are touching and there are no loose pieces.

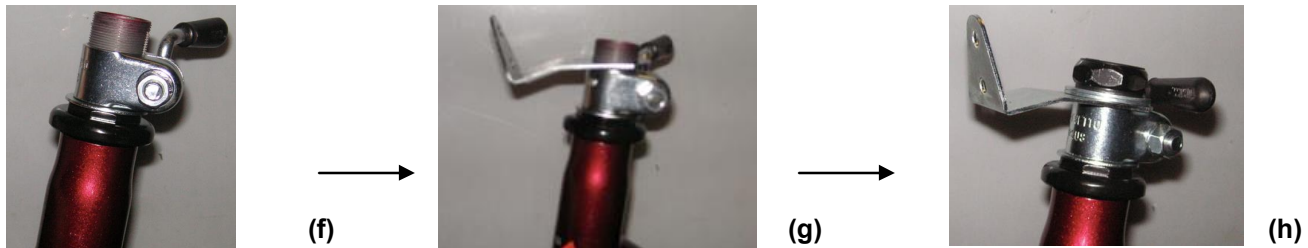

(C) Handlebar Set Up:

- Open quick-release clamp (4911B) on headset assembly.
- Insert handlebar stem (55E) into the front tube, with the head of the stem facing forward. *NOTE: Must be at least 4" into the tube, or damage to fork may occur.*
- With stem at preferred height, tighten clamp and tighten screw securely.
- Insert the handlebars (55F) into the stem opening, and place at desired angle; then simply tighten the bolt until handlebars remain in that position. Check the handlebar stiffness before riding.
- Install brake levers:
 - Remove brake levers from inside front wheel, and remove packaging.
 - Remove small bolts from each of the brake levers, and open clamps.
 - Place brake levers as seen in picture, replace the bolts, and tighten.
 - For 3 Speed Models, follow the same instructions in order to attach your gear shifter.
 - Next slide handlebar grips (55B) onto handlebars.
 - This can be done easily after soaking the handlebar grips in warm water for 30 seconds.

(D) Pedal Installation:

- Pedals are marked **L** for left, and **R** for right, on the threaded end of the pedal axle.
- Using a wrench, screw in the **R** (right) pedal onto the right side of the trike (the chain side), and similarly, screw the **L** (left) pedal onto the opposite side.
- **IMPORTANT: LEFT PEDAL TIGHTENS COUNTERCLOCKWISE!**
- Attempting to insert pedals on wrong sides will damage the threads on the pedals. *DAMAGE BY FAILURE TO FOLLOW INSTRUCTIONS WILL NOT BE COVERED BY WARRANTY.*



L and R are written on these surfaces

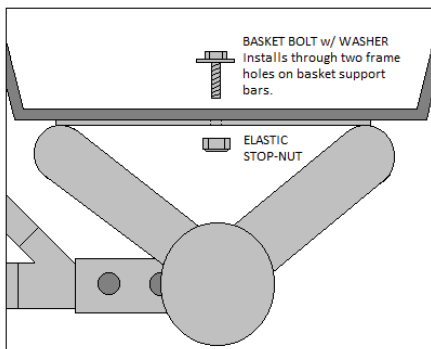

(E) Rear Cargo Basket Installation:

- Place basket on the rear of the frame, centering the basket between the rear two wheels.
- Place washers onto the basket bolts.
- Place both bolts through the outer hole in the basket, through the holes in the frame, and then install the two elastic stop nuts under the frame into the bolts. *(You will need two wrenches to tighten these bolts fully. It will get more difficult to turn the wrench as the bolt starts to grab the elastic in the nut.)*

(F) Seat Installation:

- Place seat post into clamp located on bottom of seat. Place at desired angle and tighten securely.
 - Make sure that the seat post is all the way through the clamp.
- Place other end of seat post through the quick-release clamp (black handle) at desired height and close clamp. Tighten bolt on clamp to ensure that the seat will not move when user sits on the trike.
 - When placing seat at desired height, make sure that the seat post is at least 3.5 inches inside the seat post tube.

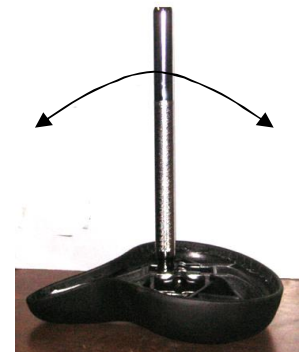

(G) Reflection Placement and Installation:

- There are a total of 5 reflectors:
 - 3 curved rectangular white reflectors for each wheel.
 - 1 square white reflector for front.
 - 1 square red reflector for rear.
- Rear Reflector:
 - Screw through the mount located on the rear cargo basket using the small screw given.

- Front Reflector:
 - Screwed on the same way as the Rear reflector, but it attaches to the front reflector bracket that was previously installed with the headset assembly. Make sure that the two locator-knobs fit into the holes in the bracket.
- Wheel Reflectors:
 - These reflectors install on the inside of the two layers of spokes. The reflector has a groove that will be facing you that will be placed onto a spoke. When this is done, place the bolt given to you through the whole, and tighten the nut on the opposite side- this should sandwich the spoke between the bolt and the reflector, and secure the reflector in position.

WHEEL REFLECTORS

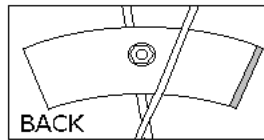
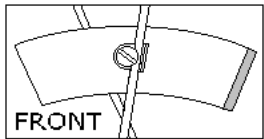

Make certain to read the manual prior to riding. Make certain to understand the rules of the road and safety instructions. Do not ride cycles after dark. In dusk or dawn, lights are recommended. Use of a helmet is always a good precaution, and may be required by law. Inspect your cycle regularly for wear of parts and replace as required. Only use factory original replacement parts. Lubricate chain, caliper brake pivot bolt and other parts as necessary and at least once every 6 months.

How to Fold Your Workman Folding Port-o-Trike Tricycle

To fold, pull the Safety-Loc lever to the loose position. Pivot the lever toward the side of the tricycle. Lift up on the arm, releasing the pin from the Safety-Loc hinge pinhole. You will then be able to fold the frame. Be careful to position the pedals for wheel clearance. (The front wheel should tuck in toward the rear of the frame to the inside of the left wheel.) To refold, see Section A of these instructions. *It is advisable to place grease in the pinhole on the frame hinge every so often so the "Safety-Loc" system works easily.*



Owner's Responsibility:

- 1) Make certain that all assembly instructions have been followed and that the tricycle is safe and ready to ride.
- 2) Perform maintenance as needed, and provide instructions to anyone who may ride the cycle.
- 3) Conform to all local regulations, including traffic laws, and be deemed physically fit to ride a cycle.

Where and How to Ride a Three Wheeler: It is recommended that you ride in areas that are paved and relatively flat. Avoid steep hills and naturally ride where you feel safe. Low traffic areas are most desirable. Sit up straight when going straight. When turning, you should lean ever so slightly into the direction of the turn. Slow down prior to making a turn. Never make sharp turns. Steer by pointing the front wheel in the direction you wish to go. Note - Tricycles have a tendency to pull slightly to the left. This is common in all three wheelers.

It is common to hear some clicking noise that emanates from the chain when the tricycle is new. This will stop when the chain is broken in. (Chains stretch slightly when new.)

Brakes and 3 Speed Coaster Brake Information: Port-o-Trikes are equipped with a front caliper, drum brake, or both. Operate the hand brake by squeezing the hand lever on the handlebar. Coaster brakes (foot brakes) are engaged by pedaling backwards until the brake operates. It is best to gently slow the cycle down using the hand brakes and completing the stop using the coaster brake. For those models with the 3 speed coaster brake, simply use the handlebar mounted shifter to select the desired gear. Gear 1 is the easiest gear for easier starting or going up hills, while gear 2 and 3 are useful once you get to your desired riding speed. Select the gear that suits your individual taste and comfort level. **DO NOT SHIFT AND PEDAL AT THE SAME TIME. PAUSE PEDALLING, SHIFT, AND RESUME PEDALLING.**

Axle Bearings: Be sure to lubricate rear axle and wheel bearings every six months. Use a bearing lubricant, which is available at any hardware or auto parts store. Failure to lubricate axle bearings can cause the bearing to seize and cut through the axle. If you hear a grinding or hissing sound, lubricate bearings immediately or replace if damaged!

Replacement Parts List: (PT, PT2F, PTCB, PT3CB)

Please note that there are two styles of PT rear axles and drive wheels. Style A uses a round drive plate welded to the axle with three prongs that protrude into three holes in the hub of the drive wheel. Style B uses a keyway, which is a rectangular piece of steel that slips between a groove in the axle and a slot in the drive wheel hub. See illustrations below to determine which style you have before ordering any replacement parts.

Front End Assembly

153	Front Fork (specify color)
50B-V	Head Parts Set
4911B	Quick Release Clamp (fork)
48B	Ball Cup (Upper) for frame head tube
48C	Ball Cup (Lower) for frame head tube
49B	Bearings for Headset (pair)
51B	Fork Bottom Cone (presses onto fork)
52B	Threaded Top Adjusting Fork Cone
53	Key Washer (Thin - Lower)
53B	Key Washer (Thick - Upper)
53BWO	Key Washer (Thin - w/o tab)
54B	Top Fork Lock Nut
55B	Hand Grips (pair)
55E	Handlebar Stem
55F	Handlebar
5030F	Reflector Bracket

Frame Parts

3200CB	Frame (Specify color)
4908K-S	Safety-Loc hinge bolt / lever parts kit

Seat and Related Parts

4908D	Seat post (1+x 15+w/ 7/8+top)
6911V	Saddle Wide (with springs - optional)

Front Wheel and Related Parts

M20F	Front Wheel w/o Drum w/o Tire
M20F-AL	Front Wheel w/o Drum w/ Alloy Rim
467A	Front Drum Brake Wheel w/o Tire
467	Front Drum Brake Wheel w/Tire
467A-AR	Front Drum Wheel w/ Alloy Rim
G250	Front Drum Brake (Hub only!)
G219	Brake Cable and Casing: Drum Brake
G220	Brake Cable and Casing: Caliper Brake

Rear Free (Left Side) Wheels

468A	Rear Wheel w/ 2 bearings w/o tire
468	Rear Wheel w/ 2 bearings w/ tire
468A-AR	Rear Wheel w/ 2 bearings w/ Alloy Rim

Tires, Tubes, Wheel Parts

6012W	Tire 20x1.75 White Wall
6012R	Tire 20x1.75 Red Line
6012A	Tube 20x1.75
1017A	Rim Strip
1014H	Spoke for front drum wheel (Sold Qty 36)
1014I	Spokes for rear wheels (Sold Qty 36)
M20	Rim Only (not a built wheel)
F820L	Non-Locking Brake Lever . Left (Std)
F820R	Non-Locking Brake Lever . Right (Std)
F852L	Locking Brake Lever . Left (Optional)
F852R	Locking Brake Lever . Right (Optional)

WHEN ORDERING WHEELS WITH TIRES, BE SURE TO SPECIFY WHICH TIRES YOU NEED.

Crank Assembly and Parts

7217	Pedals (pair)
1265	Crank Parts Set (All parts inside crank housing)
3275	Crank (5.5+)
1380C	Front Sprocket 36T
1267G	Complete Crank set (1265, 3275, 1380C)

Fenders (Plastic is standard as of 2012)

4800	Front Fender (Chrome)
4809	Rear Fender (Chrome)
FS20	Rear Fender Kit Complete (Chrome)
4800L	Front Fender w/ Hardware (Chrome)

Plastic

4800C-BLK	Front Fender w/ Hardware (Plastic)
4800CR-BLK	Rear Fender (Plastic)
FS20P	Rear Fender Kit Complete (Plastic)

Fender Parts

4802	U-Brace: Front Fender
95	L-Bracket: Front Fender
4811	Brace w/ Clamp: Rear Fender (Each)

4911A	Quick Release Clamp for Seat Post
7910V	Saddle- Wide (w/o springs - standard)

Rear Axle and Related Parts

Note Style A & Style B replacement parts! (See diagrams.)

PARTS FOR EITHER STYLE A OR STYLE B

57	Rear Axle Elastic Lock Nut
4129A	Rear Freewheel Sprocket (PT, PT2F)
62B	Set screw for 62 or 69B
62C	Keyway for 62 or 69B
174W	Rear Axle spacer washer

STYLE A AXLE PARTS (5/8+axle w/ 3-prong drive plate)

174HD	Bearing for rear axle/wheels (cartridge style 5/8+)
176	Rear Axle w/ drive plate (round disk w/ 3 prongs)
62	Bushing (5/8+for 4129A)
69B	Fixed Drive Sprocket (5/8+PTCB, PT3CB)

STYLE B AXLE PARTS (3/4+axle center w/ keyed drive slot)

173	Bearing for rear axle (cartridge style 3/4+)
174HD	Bearing for rear wheels (cartridge style 5/8+)
176K	Rear Axle w/ keyway slot
61	Bushing (3/4+for 4129A)
69A	Fixed Drive Sprocket (3/4+PTCB, PT3CB)

Rear Drive (Right-Side) Wheels

468DA	Rear Drive Wheel w/o tire (Style A)
468D	Rear Drive Wheel w/ tire (Style A)
468DA-AR	Rear Drive Wheel w/o tire w/ Alloy Rim (Style A)
468KA	Rear Drive Wheel w/o tire (Style B)
468K	Rear Drive Wheel w/ tire (Style B)
468KA-AR	Rear Drive Wheel w/o tire w/ Alloy Rim (Style B)

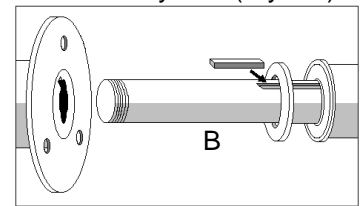
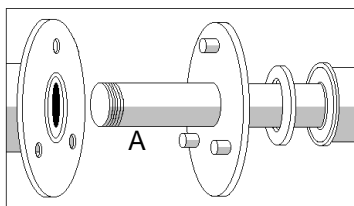

Transmission and Related Parts

301 Coaster Brake Hub (PTCB)	404SA 3 Speed CB Hub w/ Shifter (PT3CB)
4914HC Chain 1/2x1/8x97 links (PT, PT2F)	4914M Chain Connecting Link
4914E Chain-Short (PTCB, PT3CB)	4914L Chain-Long (PTCB, PT3CB)
4914R Chain half-link:1/2+x 1/8+	4916 Chain Idler Sprocket
4910P-PT-BLK Chainguard (Black Plastic)	

Miscellaneous Parts

5927BLK-C Rear Basket (Black Vinyl Coating)	SA14-1 3 Speed Shifter and Cable (Sturmey Archer**)
5030T Reflector Kits for Tricycles	

** On 3 speed models, please note the brand and shifter style. Your Worksman PT3CB will be equipped with a quality 3 speed and shifter, but brand and shifter style may vary. Parts listed here are the most commonly used Sturmey Archer style. For Shimano Parts, call 718-322-2000.

Accessories . Options and accessories are always being added! Visit www.worksmancycles.com for a complete list!

3979 Ding Dong Bell	3973 Battery Operated Mega-Horn
303 Squeeze Bulb Horn	3961 Cup Holder
101710 Flashing Strobe Light- White Lens	101714 Flashing Strobe Light- Red Lens
7917T1 Back Rest	133WH Front Basket w/ bracket (Easily removable w/ handles!)
7217GS12 Flashing Light Pedals (Very cool!)	202 Mini Frame Air Pump
1006 Foot Pump	201 Cable and Pad Lock w/ Key
P19 Adult Helmet	

Limited Warranty: Commercial use voids this warranty. This is a consumer model. Worksman makes a full array of industrial and recreational cycles. Shipping issues or damage must be reported within 15 days of receipt. Only one (1) warranty shipment will be made per order, so inspect cycle fully before reporting damage. This cycle is warranted against faulty parts under the following conditions: This warranty does not cover any failure due to accident, abuse, misuse, neglect, or as a result of normal wear and tear, or by assembly errors performed by a non-qualified mechanic. The frame including all welded joints is warranted to be free of defects in material and workmanship for one (1) year while in the possession of the original purchaser. All other parts on this cycle (except tires and tubes) are warranted for 90 days from date of purchase. Proof of purchase is required for any claims being considered. The manufacturer reserves the right to have all defective parts returned at purchasers expense for examination prior to resolving the claim. If upon examination the manufacturer deems the part to be defective and within the warranty period, a replacement part will be sent at no charge. Unauthorized repair of parts voids warranty. Proper maintenance is required for the warranty to be valid. If it is determined by the manufacturer or the dealer that the part in question is not covered under warranty, we will advise the cost to repair or replace the part. The sole responsibility of the manufacturer pursuant to the terms of this warranty is the replacement or repair of the parts in question. The liability of the manufacturer shall in no event exceed the original purchase price of the model and the manufacturer shall not be liable for any consequential damages of any nature including but not but not by way of limitation damages for personal injuries or to property. This statement constitutes the exclusive expression of warranties by the manufacturer and is in lieu of any and all other warranties including expressed warranties, any implied warranties, including but not limited to warranties of merchantability and fitness or purpose, are limited in duration to one year of purchase for the frame (excludes fork) and ninety (90) days for other parts as covered in this warranty. Cycles are not intended for off road use, stunt riding or similar activities. Should an approved electric bicycle assist be added to the cycle, the purchaser is responsible for meeting any local laws. Such modifications void warranty. Void where prohibited by state law. The seller is not responsible for typographical errors or omissions. Manufactured by Worksman Trading Corporation.

Braking System
&
Recommended Weight Capacity

	FT Drum	FT Caliper	C/B	3 Speed C/B	Recommended Weight Capacity
PT	X				210
PT2F	X	X			215
PTCB	X		X		225
PT3CB	X			X	225

Visit www.worksmancycles.com to see our full line of quality Worksman Cycles!

When you need a unique specialty cycle, call **WORKSMAN CYCLES!**

INDUSTRIAL HEAVY-DUTY TRICYCLES



Worksman Adaptable Tricycles



Worksman Front-Load Tricycles

Worksman Executive Trike



Worksman Chariots

Worksman Mover Tricycles



WORKSMAN HEAVY-DUTY INDUSTRIAL & DELIVERY BICYCLES, CRUISERS, FOLDING BICYCLES

WORKSMAN RECREATIONAL TRICYCLES FOR ADULTS AND CHILDREN



www.worksman.com 888-3-WHEELER